



TECHNICAL SPECIFICATIONS

GENERAL	Type desktop/console	Full-Colour desktop	Warm-Up Time	37 seconds B&W, 40 seconds Colour
	Technology	Electrophotographic laser Tandem, indirect	Power Consumption	Less than 1.250 W
	CPU	Power PC440EP 667 Hz	Paper Capacity (80 g/m²)	Std.: 250 sheets Max 3.350 sheets (with 3 cassettes)
	System Memory	576 MB (1088 MB max)	Automatic document feeder	Max 70 sheets
	First Copy Time	< 10 seconds in B&W < 13.5 seconds Colour	By-pass (opt.)	100 sheets
	System speed	Up to 20 ppm in colour and B&W (A4), Up to 9.8 ppm colour and B&W (A3)	Paper output capacity	Max 1.200 sheets
	Original format	Max A3	Automatic duplex (opt.)	A5 - A3 wide (64-256 g/m ²)
	Paper size	A3-A5, A3 wide, A6	Dimensions (WxDxH)	620 x 688 x 648 mm
	Paper weight	Universal cassettes: 60-256 g/m ² Multi by-pass tray: 60-256 g/m ²	Weight	Approx. 68 kg
	Greyscale	256 levels		
Power Requirements	220-240V 8A 50/60Hz			
COPIER	Resolution	600 x 600 dpi	Copy features	Chapter and cover mode, proof copy, adjustment test print, glossy mode, colour adjustment digital art, job recall, job setting memory, postre mode, overlay, stamping
	Multicopy	1-9.999, interruption mode		
	Zoom	25-400% (0,1 % step)		
PRINTER	Resolution	600 x 600 dpi	Functions	Direct print of PCL, PS, TIFF and PD, overlay, print protection
	Languages	PCL5e/c, PCL XL 3.0, PostScript 3 (3015)	Operating System	Windows 2000/XP/XP64/Vista, XP/Vistax64 edition
	Interfaces	Ethernet 10-Base-T/100-Base-TX, USB 2.0 compatible		
SCANNER	Type	Colour scanner	Interfaces	Ethernet 10-Base-T/100-Base-TX
	Scan speed	20 spm colour (300 dpi) 40 spm B&W (300 dpi)	Protocol	TCP/IP (FTP, SMB, SMTP)
	Resolution	Max 600 x 600 dpi	Operating System	Windows /2000/XP/Vista, Mac OS 10.2 or later
	Scan mode	Scan to e-Mail, Scan to FTP, Scan to PC (SMB) Network TWAIN (via Ethernet TCP/IP)	File format	TIFF and PDF standard, JPEG
FAX	Compatibility	PSTN, PBX	Diver	TWAIN
	Resolution	400 dpi	Transmission time	< 3 seconds (A4, V.34, 33,6 kbps, JBIG)
	Transmission speed	Up to 33,6 kbps	Scan speed	40 spm B&W (300 dpi)
	Compression methods	MH, MR, MMR, JBIG	Memory	Shared with copier
	Original format	Max. A3	Functions	Fax via IP

Product performances are referred to an appropriate use under optimal conditions. With the right to change technical specifications. The registered trademarks are the property of their respective owners. d-Color MF201 is distributed by Olivetti S.p.A. (09/08) - Code: 26733-00



d-COLORMF201

MULTI-FUNCTION COLOUR DIGITAL SYSTEM

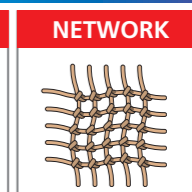
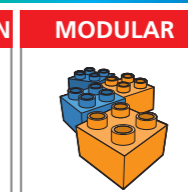
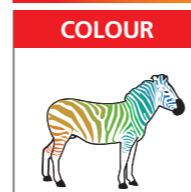

d-COLORMF201

MULTI-FUNCTION COLOUR DIGITAL SYSTEM

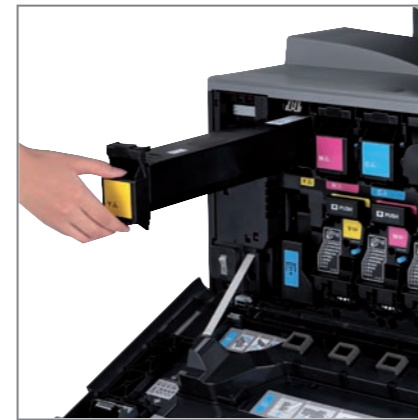

POLYMER TONER for high-quality printing



200-sheet PAPER TRAY with 2 outlets



Vertically tilting CONTROL PANEL

COLOUR FOR EVERYONE

A robust multi-function colour digital system, for heavy-duty needs and medium-size work groups where corporate image and return on investment are key priorities.

FAX

The d-Color MF201 offers an **optional fax capability integrated with the corporate intranet or extranet**, for faster, lower-cost transmission.

A **host of functions** are available with the fax option, including digital fax store, internet fax, PC fax (for Windows only) and IP address fax, which keeps down the cost of sending b/w documents by selecting the receiver device's IP address.

SCANNING

The scanner capability scans documents, converts them into digital data and can also send them to different destinations, in PDF, TIFF and JPEG formats (b/w only), using scan TWAIN, scan-to-SMB, scan-to-mail, scan-to-FTP functions.

To save even more time, the **Multi-Method Send capability** sends documents via fax and e-mail to multiple destinations with a single operation, simultaneously with other transmissions (SMB or FTP).

MAIN CHARACTERISTICS

COPIER, PRINTER AND SCANNER	POLYMER TONER FOR SUPERIOR PRINTING QUALITY
G3 FAX WITH INTERNET FAX, IP ADDRESS FAX FUNCTIONS*	PCL AND POSTSCRIPT 3 PRINT LANGUAGES
MODULAR ARCHITECTURE	PAPER MANAGEMENT UP TO 3,350 CUT SHEETS (256 g/m ²)

* optional

MULTI-METHOD SEND



FAX

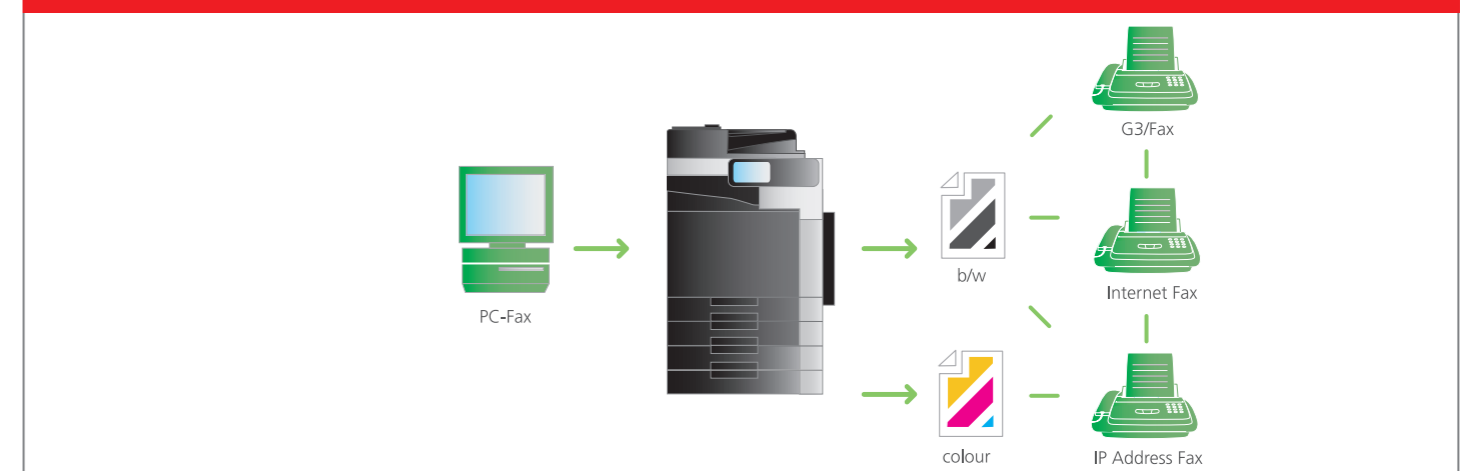

MODULARITY

The Olivetti d-Color MF201 can be enhanced with a **range of options** to suit individual user needs. The basic configuration, a top performer in its product category, supports the following optional devices: a duplex for front-back printing, a 100-sheet multi-bypass, A3 and A4 paper trays with different capacities, an additional memory board and a 70-sheet document feed.

QUALITY

The **innovative polymer toner**, consisting of minute uniform particles, ensures outstanding printing quality and unbeatable sharpness. The toner's chemical formula delivers fade-resistant print-outs for storage without any loss in brightness, tone and colour contrast.

PRINT CONTROLLER

For **efficient daily operations**, the new-generation print controller integrates all network processes in the Windows, Macintosh, Unix and Citrix environments. All the systems adopt the **same user interface** encompassing all PCL and PostScript languages.

DESIGN

The system can be easily **installed in any office environment**, even on a desk. Ergonomic features include a vertically tilting control panel, easy-grip paper trays and front-facing access to consumables.